

RILEY COUNTY KANSAS

LEGEND

- PAVED ROADS**
- U.S./State Divided Highways
 - U.S./State 2-Lane Highways
 - County Roads
 - Township/City Roads
- GRAVEL ROADS**
- County Roads
 - Township/City Roads
- UNIMPROVED ROADS**
- Township/City Roads
- TRAILS**
- Township/City Roads
- UNDEVELOPED RIGHT-OF-WAY**
- Township/City Roads
- MISCELLANEOUS**
- Private Roads
 - Section Lines
 - Hydrology
 - City Outlines
 - Parks
 - Subdivisions
 - Unincorporated Town
 - Houses/Buildings
 - School
 - Church
 - Cemetery

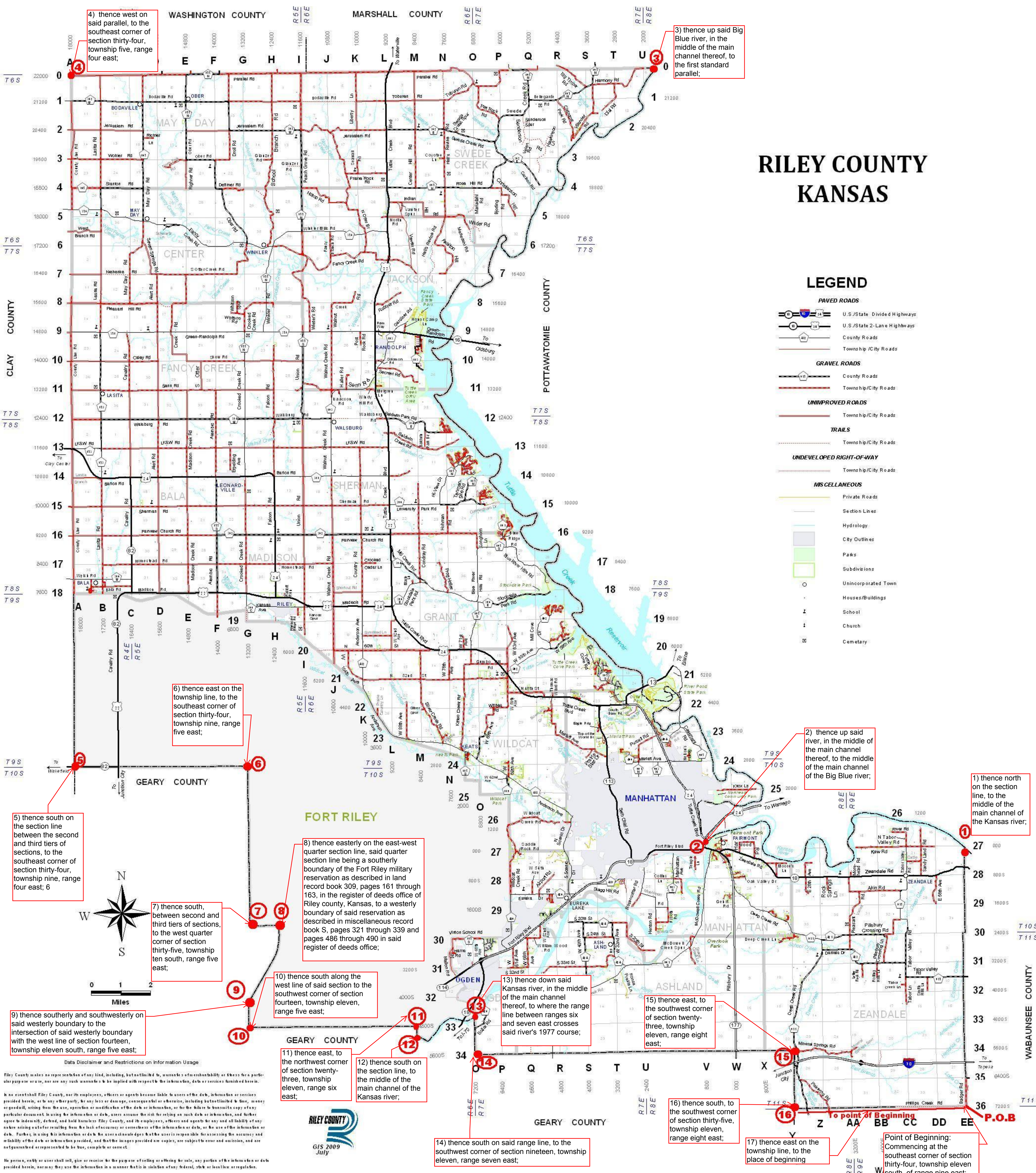

4) thence west on said parallel, to the southeast corner of section thirty-four, township five, range four east;

3) thence up said Big Blue river, in the middle of the main channel thereof, to the first standard parallel;

6) thence east on the township line, to the southeast corner of section thirty-four, township nine, range five east;

5) thence south on the section line between the second and third tiers of sections, to the southeast corner of section thirty-four, township nine, range four east; 6

7) thence south, between second and third tiers of sections, to the west quarter corner of section thirty-five, township ten south, range five east;

8) thence easterly on the east-west quarter section line, said quarter section line being a southerly boundary of the Fort Riley military reservation as described in land record book 309, pages 161 through 163, in the register of deeds office of Riley county, Kansas, to a westerly boundary of said reservation as described in miscellaneous record book S, pages 321 through 339 and pages 486 through 490 in said register of deeds office;

10) thence south along the west line of said section to the southwest corner of section fourteen, township eleven, range five east;

9) thence southerly and southwesterly on said westerly boundary to the intersection of said westerly boundary with the west line of section fourteen, township eleven south, range five east;

11) thence east, to the northwest corner of section twenty-three, township eleven, range six east;

12) thence south on the section line, to the middle of the main channel of the Kansas river;

14) thence south on said range line, to the southwest corner of section nineteen, township eleven, range seven east;

13) thence down said Kansas river, in the middle of the main channel thereof, to where the range line between ranges six and seven east crosses said river's 1977 course;

15) thence east, to the southwest corner of section twenty-three, township eleven, range eight east;

16) thence south, to the southwest corner of section thirty-five, township eleven, range eight east;

17) thence east on the township line, to the place of beginning

2) thence up said river, in the middle of the main channel thereof, to the middle of the main channel of the Big Blue river;

1) thence north on the section line, to the middle of the main channel of the Kansas river;

Point of Beginning: Commencing at the southeast corner of section thirty-four, township eleven south, of range nine east;

Data Disclaimer and Restrictions on Information Usage

Riley County makes no representation of any kind, including, but not limited to, warranties of reasonableness or fitness for a particular purpose or use, nor are any such warranties to be implied with respect to the information, data or services furnished herein.

In no event shall Riley County, nor its employees, officers or agents become liable to users of the data, information or services provided herein, or to any other party, for any loss or damage, consequential or otherwise, including but not limited to time, money or goodwill, arising from the use, operation or modification of the data or information, or for the failure to transmit a copy of any particular document in using the information or data, users assume the risk for relying on such data or information, and further agree to indemnify, defend, and hold harmless Riley County, and its employees, officers and agents for any and all liability of any nature arising out of or resulting from the lack of accuracy or correctness of the information or data, or the use of the information or data. Further, in using this information or data the user acknowledges that the user is responsible for assessing the accuracy and reliability of the data or information provided, and that the images provided are copies, are subject to error and omission, and are not guaranteed or represented to be true, complete or correct.

No person, entity or user shall sell, give or receive for the purpose of selling or offering for sale, any portion of the information or data provided herein, nor may they use the information in a manner that is in violation of any federal, state or local law or regulation.

